

RS aero

Rigging Guide

Mainsheet Cleats V1



PLEASE FOLLOW ASSEMBLY GUIDE IN THE CORRECT ORDER

RS
aero

TOOLS REQUIRED:

- Drill
- 2.5mm drill bit
- Countersink
- Pozidrive screwdriver

CONTENTS:

2 X mainsheet cleats

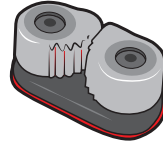

2 x thick cleat base



4 x screws



1.

- Place the thicker base plate on the deck with it's undergrooves pointing inboard. It is positioned in the gap in the non-skid. There is a wooden block underneath.

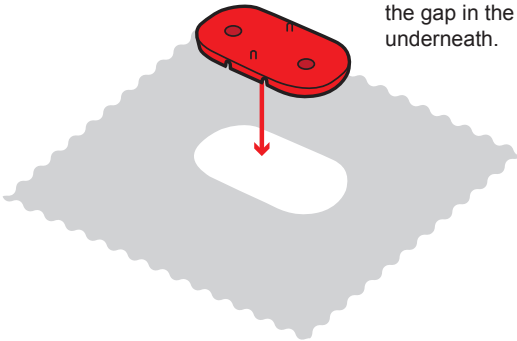

2.

- Tie a piece of line to the mainsheet ratchet block attachment eye and hold it across the cleat position. Ensure that the base plate is at right angles to this line.

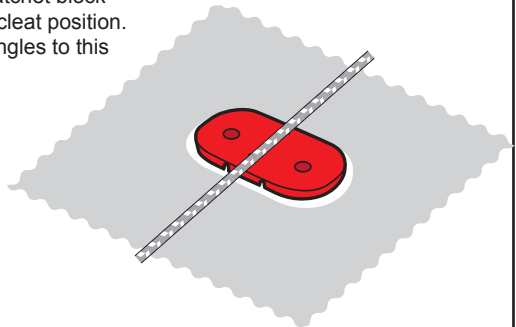

3.

- Drill 2 holes using a 2.5mm drill bit.
- Use a countersunk bit to remove a small amount of gelcoat from around the 2.5mm holes.

4.

- Replace the thin red harken cleat base plates with the slightly thicker plates provided.

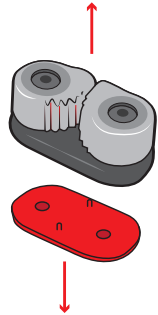

5.

- Squeeze some sealant into the holes, then screw the cleats to the deck with the 2 inch 8 gauge panhead self-tappers provided.
- Check the screws have not been overtightened and the cams move freely.
- Wipe any excess sealant off with white spirit.

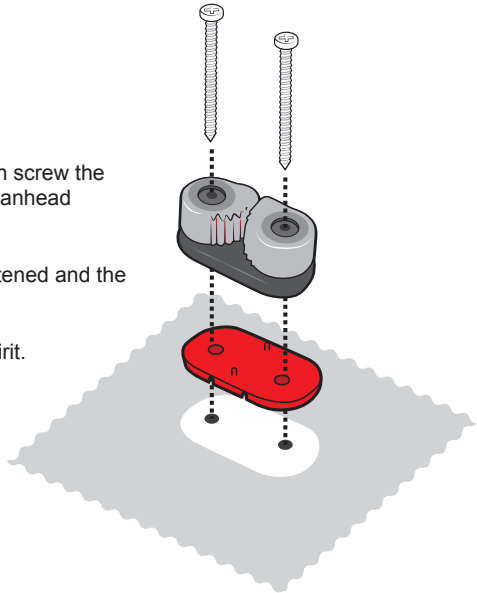

Make sure cleat opens outwards.



If overtightened the jaws may not close properly.