

# *RS* aero

Rigging Guide

Mast Collar Repair Kit V2



PLEASE FOLLOW ASSEMBLY GUIDE IN THE CORRECT ORDER

*RS*  
aero



# RS **aero** Mast Collar Repair Kit

## Pack contents:

- 1 x Aero Mast collar
- 1 x RS Aero Mast heel plug
- 1 x Araldite adhesive
- 1 x Sand paper
- 1 x Masking tape
- Mixing sticks
- Nitrile Gloves
- 1 x 8 x ¾ csk Pozi self-tapping screw
- 1 x pop rivet

## Other tools required:

- Sharp Knife
- Drill
- 5mm and 7mm drill bit
- Hot air gun (hair dryer)
- Bench Vice / Work mate
- Tape Measure
- White Spirit or Acetone



Check the pack has all the listed contents before you start



1)

Place the mast bottom section horizontally in a padded vice / workmate.

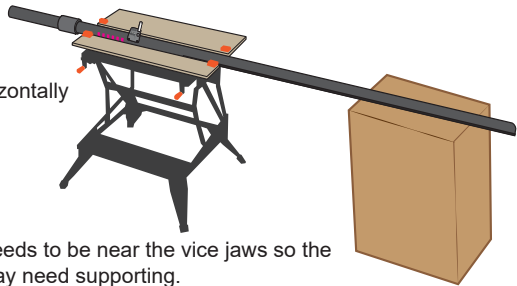

The collar needs to be near the vice jaws so the other end may need supporting.

2)



The mast heel plug is secured with either a rivet or screw. Drill off the head of the mast heel plug securing rivet or remove the retaining screw.

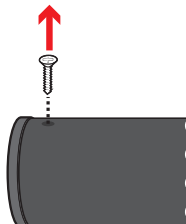

# RS **aero** Mast Collar Repair Kit

3)

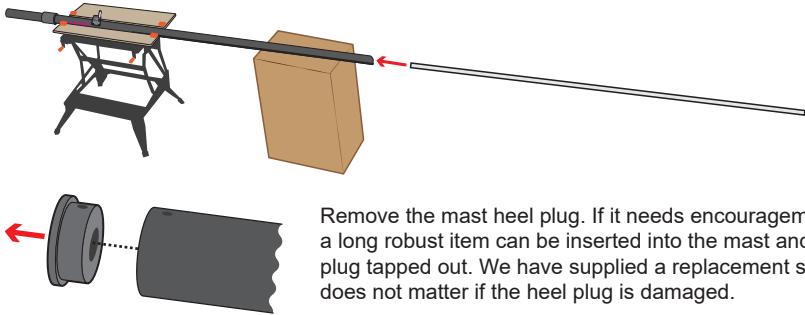

4)

Measure the correct location of the top and bottom of the mast collar from the bottom of the mast. You will need these measurements later to position masking tape and the collar itself.

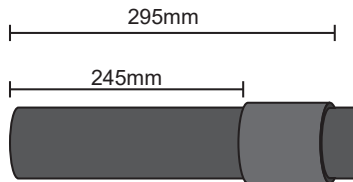

5)

Remove enough of the original glue to slide the collar down towards the mast foot. The collar may need heating with a hot air gun (hair dryer) to slide it off the bottom of the mast.



6)

Remove all of the original glue using a sharp knife and sand paper.

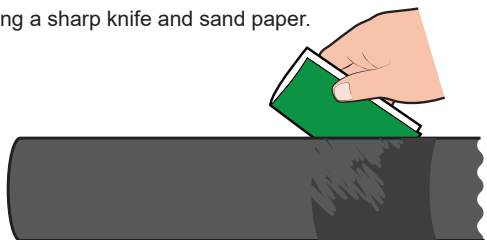

**RS**  
**aero** Mast Collar Repair Kit

7)

Mask up the top and bottom of the bonding surface.

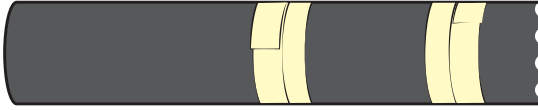

8)

Use the sand paper to key bonding surface on the mast.

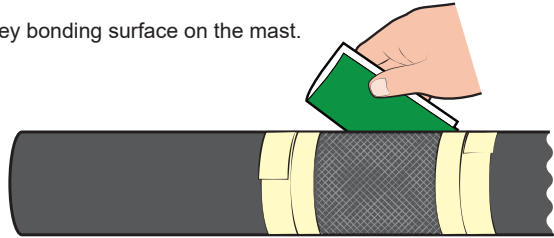

9)

Key up the inside of the mast collar with the sand paper.

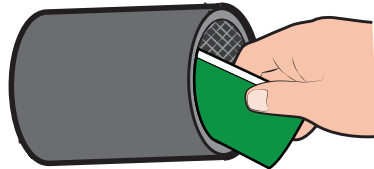

10)

Use the white spirit or acetone to degrease the collar and mast bonding surface.



Use the nitrile gloves.

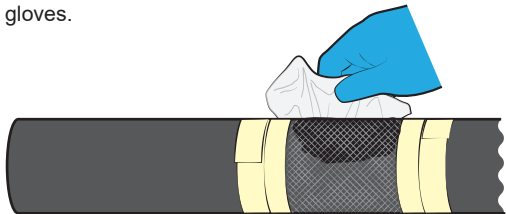

**RS**  
**aero** Mast Collar Repair Kit

11)

Follow the Araldite instructions for preparing the adhesive.

Use the wooden mixing stick to apply Araldite to the mast bonding surface.

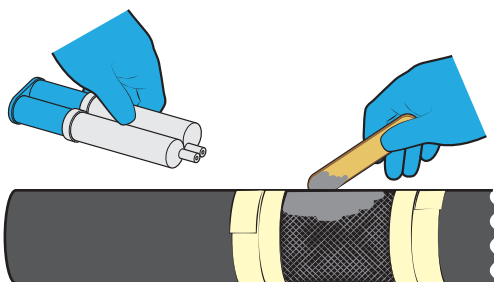

12)



Slide the collar into position.



Then move the collar up and down over the bonding surface to load the glue into the grooves.

Move the surplus glue from one end to the other so the leading edge has a donut of glue to pass through.

Do this several times until the collar grooves stop taking up the glue.



Thumb a fillet of Araldite into the top and bottom of the collar.

13)

Remove the excess Araldite from the collar with the cloth.



Double check the collar position.

Remove the masking tape and clean up any excess glue on the mast.

14)

Refit the mast heel plug and refit the rivet or screw.

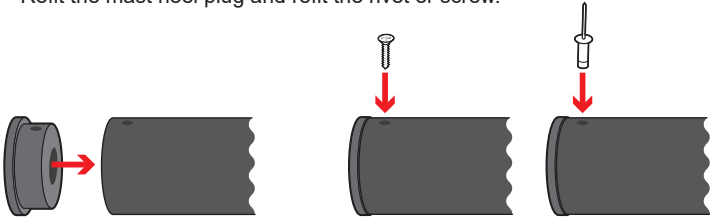

**Leave for 24hrs for the Araldite to cure**

