

RS
aero

Mast Collar Checking Process



PLEASE FOLLOW GUIDE IN THE CORRECT ORDER

RS

aero

TOOLS REQUIRED:

- Pipe Wrench
- Length of rope to attached weight
- A weight
- Clamps or vice

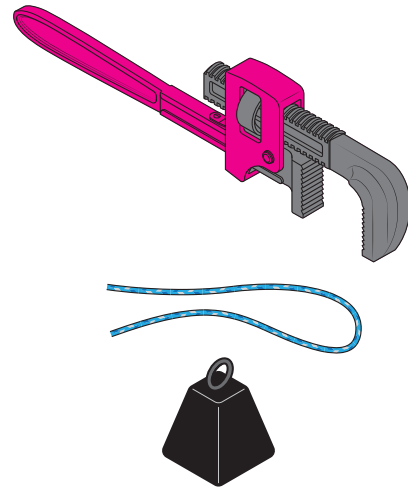

1.

Support and clamp the mast by the goose neck and at the top end.

Do not over tighten clamps. If using metal clamps or a vice ensure soft jaws are used to prevent damaging the mast.

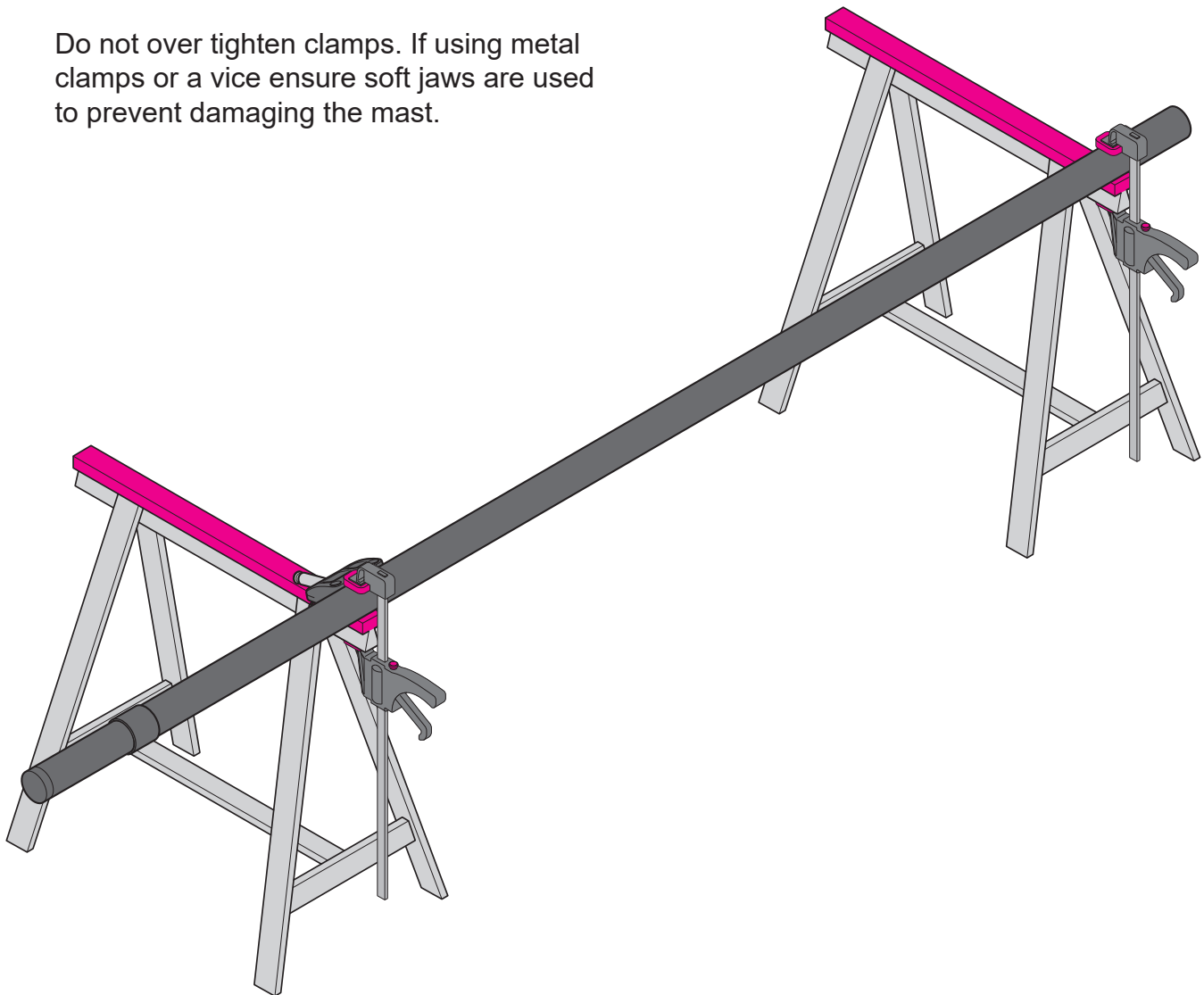

2.

Apply protective tape to the jaws of the wrench. Adjust the wrench to fit the mast collar and position the wrench so the handle horizontal.

Measure the distance from the center of the mast to a suitable mounting point on the end of the wrench.

Refer to the tables on the next page to determine how much weight is needed.

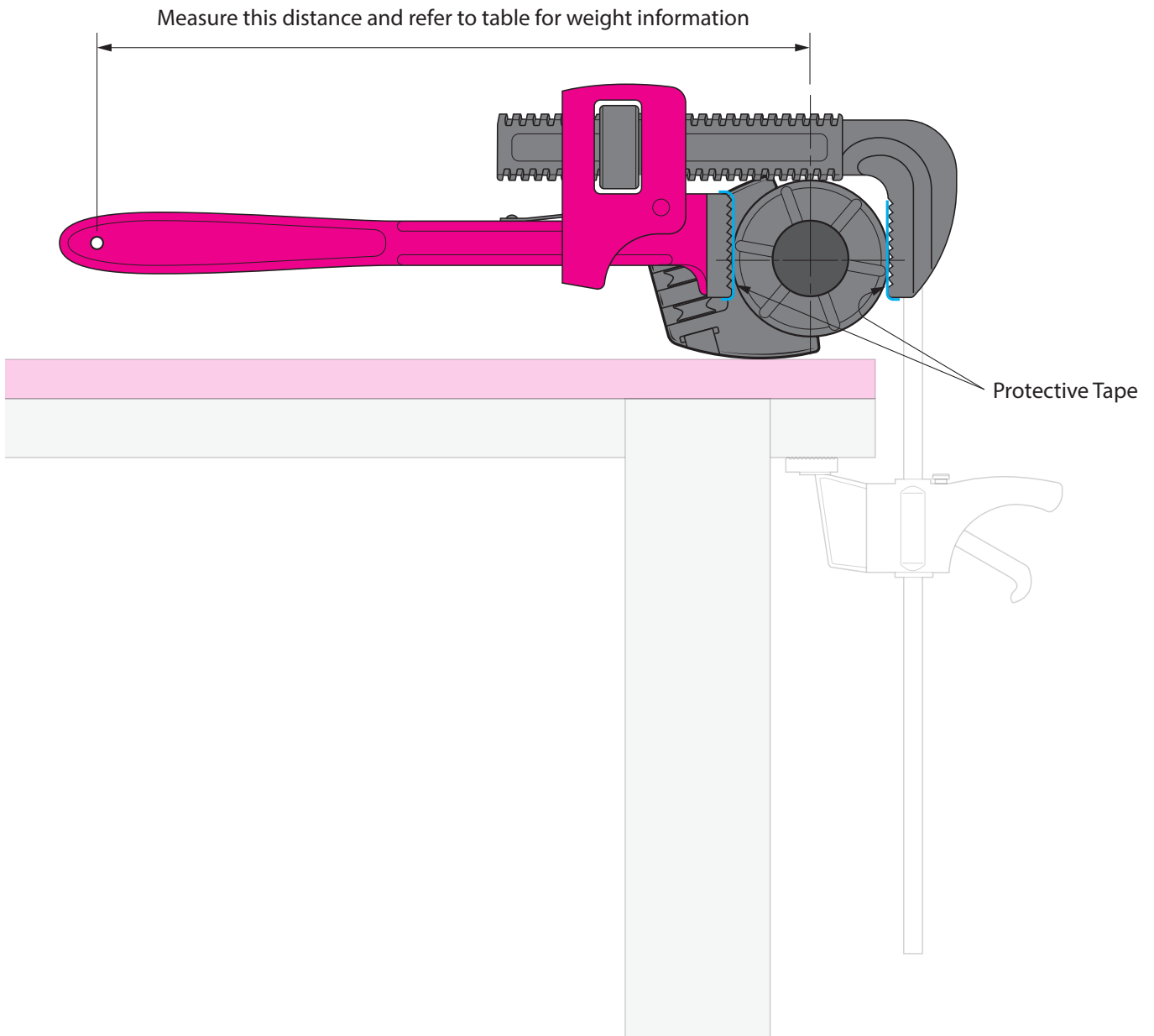

3.

Lever cm	Load kg
407.89	1
203.94	2
135.96	3
101.97	4
81.58	5
67.98	6
58.27	7
50.99	8
45.32	9
40.79	10
37.08	11
33.99	12
31.38	13
29.13	14
27.19	15
25.49	16
23.99	17
22.66	18
21.47	19
20.39	20
19.42	21
18.54	22
17.73	23
17.00	24
16.32	25
15.69	26
15.11	27
14.57	28
14.07	29
13.60	30
13.16	31
12.75	32

Lever "	Load LB
17.14	21
16.36	22
15.65	23
15.00	24
14.40	25
13.85	26
13.33	27
12.86	28
12.41	29
12.00	30
11.61	31
11.25	32
10.91	33
10.59	34
10.29	35
10.00	36
9.73	37
9.47	38
9.23	39
9.00	40
8.78	41
8.57	42
8.37	43
8.18	44
8.00	45
7.83	46
7.66	47
7.50	48
7.35	49
7.20	50
7.06	51
6.92	52
6.79	53
6.67	54
6.55	55
6.43	56
6.32	57
6.21	58
6.10	59
6.00	60
5.90	61
5.81	62
5.71	63
5.63	64
5.54	65
5.45	66
5.37	67
5.29	68
5.22	69
5.14	70

Refer to these tables to determine how much weight to add to the end of the wrench

4.

Using a suitable piece of rope attach the weight to the end of the wrench. Let the weight hang free. Observe the collar for any movement.

Carefully remove the wrench, if there is any cosmetic damage to the collar remove any high spots with a sharp blade.

This concludes the test.

